

Firebird

# RS250 Fire Equipment Cabinet



- Uniquely Lloyds Register Type Test Approved
- American Bureau of Shipping Approved
- 25 years proven track record
- IP56 rated for excellent weather protection
- Engineered to your specification



# Firebird RS250 Fire Equipment Cabinet



<b>Typical Use:</b>	Storage of Firehose and Equipment.
<b>Approvals:</b>	Lloyds Register Type Test Approved American Bureau of Shipping Approved
<b>IP Rating:</b>	IP56
<b>Dimensions mm:</b>	
<b>Height x width x depth:</b>	1756 x 903 x 460
<b>Aperture mm:</b>	1228H x 745W
<b>Internal depth mm:</b>	404
<b>Weight Kg:</b>	60
<b>Material Specification:</b>	
<b>Colour:</b>	Red RAL3000
<b>Material:</b>	3-4mm nominal thickness GRP
<b>Roller Shutter:</b>	Extreme Environment Roller Shutter
<b>Reinforcement:</b>	2 x 100mm <sup>2</sup> pads
<b>Lettering:</b>	"Fire Hose" 50mm white
<b>Optional Extras:</b>	Cabinet specification can be changed to meet your requirements

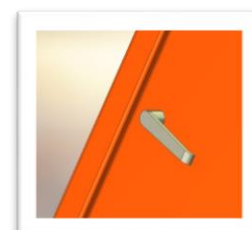
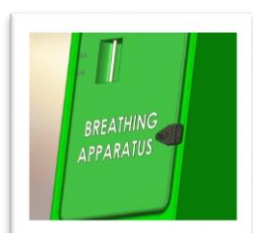
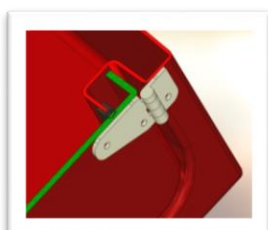

**Jo Bird & Company Ltd** Factory Lane, Bason Bridge, Highbridge, Somerset, TA9 4RN, UK  
Tel +44 (0)1278 785546 Fax +44 (0)1278 780541 info@jobird.co.uk www.jobird.co.uk